

## **CAMAS SLOUGH MAINTENANCE DREDGING NARRATIVE**

### **Shoreline Master Program Goals and Policies**

#### **3.1 General Goals and Policies**

*Use the full potential of shorelines in accordance with the opportunities presented by their relationship to the surrounding area, natural resource value and unique aesthetic qualities offered by water topography and views.*

*Develop a physical environment that is both ordered and diversified and integrates water and shoreline uses while achieving a new gain of ecological function.*

#### **3.5 Economic Development**

*3.5 (1). Current economic activity that is consistent with the policies of this SMP should continue to be supported.*

This project will be undertaken in the Camas Slough. The Columbia River and Washougal River have been designated as Shorelines of Statewide Significance.

The Camas Slough is an aquatic waterway utilized by the Camas Mill for transit and moorage of tugboats and wood chip barges to support pulp and paper manufacturing. Currently, the mill receives roughly 25 percent of its woodchip deliveries by barge. This is equivalent to about three to four barge deliveries per week. Each barge stays docked for three to five days at a time. Land on both sides of the dredging areas is owned by the mill (Lady Island and the mill proper). The Camas Slough also provides water to the mill. This water can be used for both pulp and paper processes and for fire emergencies. Thus, maintenance dredging is essential for the operations of the mill to maintain tug and barge access and the functionality of the water intake structures. The project area has been routinely dredged in the past and the current dredging project will not change the locations or depths of the proposed dredging.

#### **3.13 Water Quality and Quantity**

*3.13.2 (1): Encourage the location, construction, operation and maintenance of shoreline uses, developments and activities the focused on maintaining or improving the quality and quantity of surface and ground water over the long term.*

To minimize the impact of the dredging on water quality, a specific project scope and timing has been chosen. The dredging will take place from December 1<sup>st</sup> to January 31<sup>st</sup> when fish species are least likely to occur in the area. To dredge, the contractor will be using a slow drop clamshell to minimize turbidity and suspended solids in the water. All dredged materials will be deposited at a nearby landfill on Lady Island that is approved to hold dredge spoils. A composite sample is taken of the dredge spoils removed during the work period and analyzed. Straw bales and wattles are used to control runoff and prevent sediment from the dredging from re-entering the water column. Details for the disposal of all dredged materials are available in the Dredged Materials Landfill Operations and Closure Plan (included in this application).

## **Chapter 6 Specific Shoreline Use Regulations**

Shoreline Use Designation: Aquatic

The proposed project is Maintenance Dredging which is permitted under the aquatic shoreline designation.

### **6.4.2 Dredging**

#### *6.4.2.1 Dredging*

*(2). Maintenance dredging of established navigation channels and basins shall be restricted to management of previously dredged or existing authorized location, depth and width.*

*(3). Dredging and dredge disposal shall be prohibited on or in archaeological sites are listed on the National Register of Historic Places, the Washington Heritage Register, or the Clark County Historic Register until such time that they have been reviewed and approved by the city and the Department of Archaeology and Historic Preservations (DAHP)*

*(4). Dredging shall be prohibited between the OHWM and minus fifteen (-15) feet CRD, unless shallow water habitat will be created to mitigate for the dredging project.*

*(6). Dredging and dredge disposal shall be scheduled to protect biological productivity (including but not limited to, fish runs, spawning, and benthic productivity) and to minimize interference with fishing activities. Dredging activities shall not occur in areas used for commercial fishing (including but not limited to, drift netting and crabbing) during a fishing season unless specifically address and mitigated for in the permit.*

*(7). Dredge techniques that cause minimum dispersal and broadcast of bottom material shall be used and only the amount of dredging necessary shall be permitted.*

*(8) Dredging waterward of the OHWM shall be permitted only:*

*(a) For navigation or navigational access;*

This continued maintenance dredging proposal will comply with the regulations of this program. It will be restricted to management of existing authorized locations, depths, and widths. This project does not include dredging or disposal of materials on listed archaeological sites. Dredging will be prohibited between the ordinary high-water mark (OHWM) and minus fifteen feet (-15) according to the Columbia River Datum (CRD). Dredging will be performed, as necessary, within the authorized work window. The dredging technique to be used will be by clamshell to minimize dispersal and broadcast of bottom material. As mentioned in the SEPA and JARPA, the purpose of this dredging is for navigational access and to provide for the water dependency of the pulp and paper processes and fire emergencies.

#### *6.4.2.2 Dredge Material Disposal*

All dredged materials will be deposited at a nearby landfill on Lady Island that is approved to hold dredge spoils. A composite sample is taken of the dredge spoils removed during the work period and analyzed. Straw bales and wattles are used to control runoff and prevent sediment from the dredging from re-

entering the water column. Details for the disposal of all dredged materials are available in the Dredged Materials Landfill Operations and Closure Plan (included in this application).

## **Appendix B VII. Application**

*B.2. A current (within thirty days prior to application) mailing list and mailing labels of owners of real property within three hundred (300) feet of the subject parcel, certified as based on the records of Clark County assessor.*

Georgia-Pacific Consumer Products (Camas) LLC currently owns all of the real estate within three hundred (300) feet of the project area. A list of all real properties within three hundred (300) feet of the main mill property is included with this narrative.

*7.a. The location of the ordinary high water mark (OHWM);*

See attached 'Camas Millsite' contour map. The OHWM on this map is located at approximately 21 feet.

*7.b. The names of owners of adjacent land and the names of any adjacent subdivisions;*

Not Applicable

*7.c. Names, locations, widths and dimensions of existing and proposed public street rights-of-way, public and private access easements, parks and other open spaces, reservations, and utilities;*

Not Applicable

*7.d. Location, footprint and setbacks of all existing structures on the site with a lineal distance from OHWM;*

Currently, all dredging areas are located within the Camas Slough. The total area of proposed dredging is 23.6 acres.

*7.e. Location of sidewalks, street lighting, and street trees;*

Not Applicable

*7.f. Location of proposed building envelopes and accessory structures and the lineal distance from OHWM;*

Not Applicable

*7.g. Location, dimensions and purpose of existing and proposed easements. Provide recorded documents that identify the nature and extent of existing easements;*

Not Applicable

*7.h. Location of any proposed dedications;*

Not Applicable

*7.i. Existing and proposed topography at two-foot contour intervals, extending to five feet beyond the project boundaries;*

Not Applicable

*7.j. Location of any critical areas and critical area buffers, to indicate compliance with all applicable provisions of the critical areas legislation, as required under CMC Title 16;*

Not Applicable

*7.k. Preliminary stormwater plan and report;*

Not Applicable

*7. l. Description, location and size of existing and proposed utilities, storm drainage facilities, and roads; and*

Not Applicable

*7.m. A survey of existing significant trees.*

Not Applicable

*7.n. For properties with slopes of ten percent or greater a preliminary grading plan will be required with the development application that shows:*

- i. Two-foot contours;*
- ii. The proposed development and existing topography;*
- iii. The proposed development with proposed topography; and*
- iv. Total quantities of cut and fill.*

Not Applicable

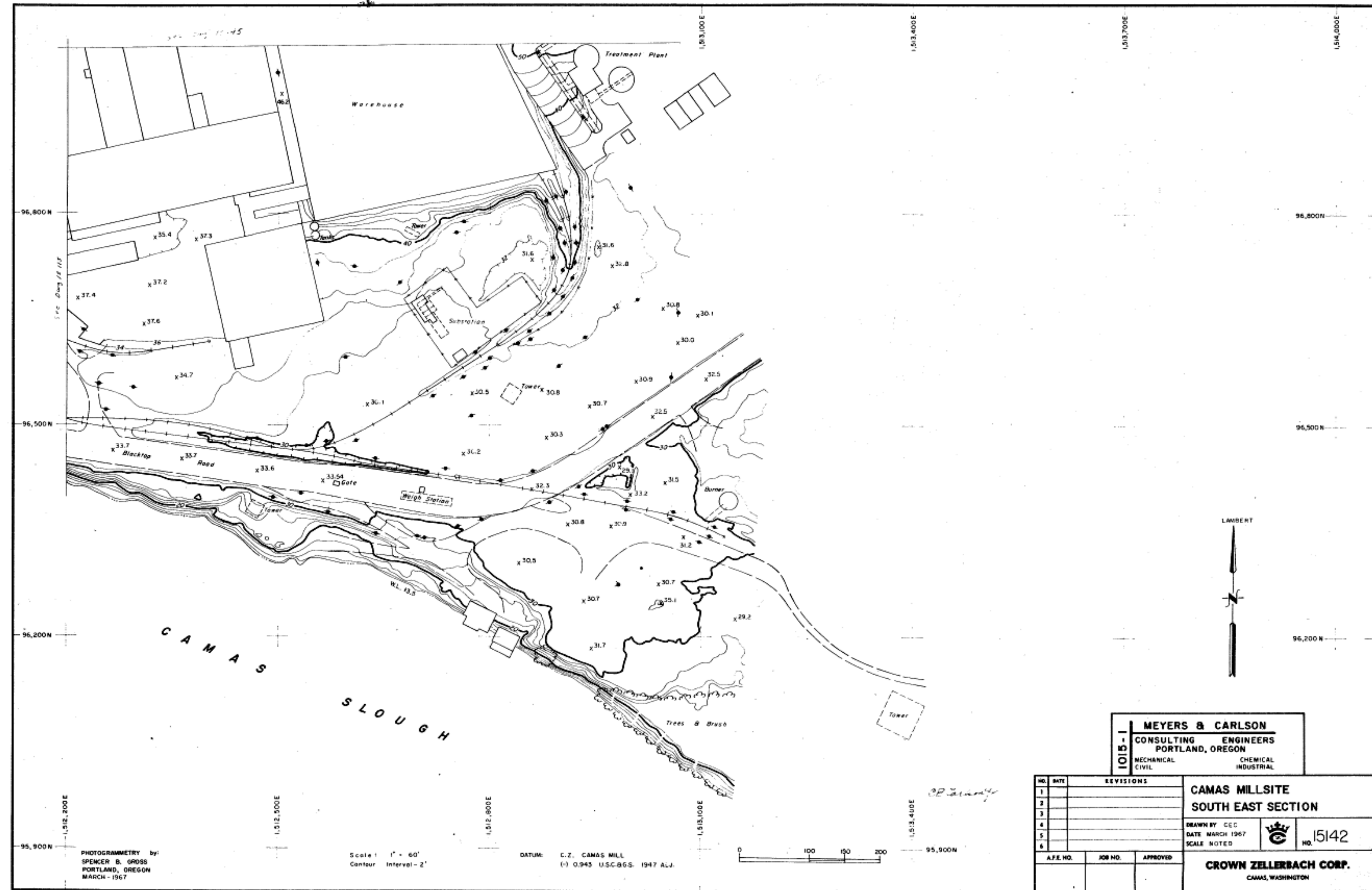

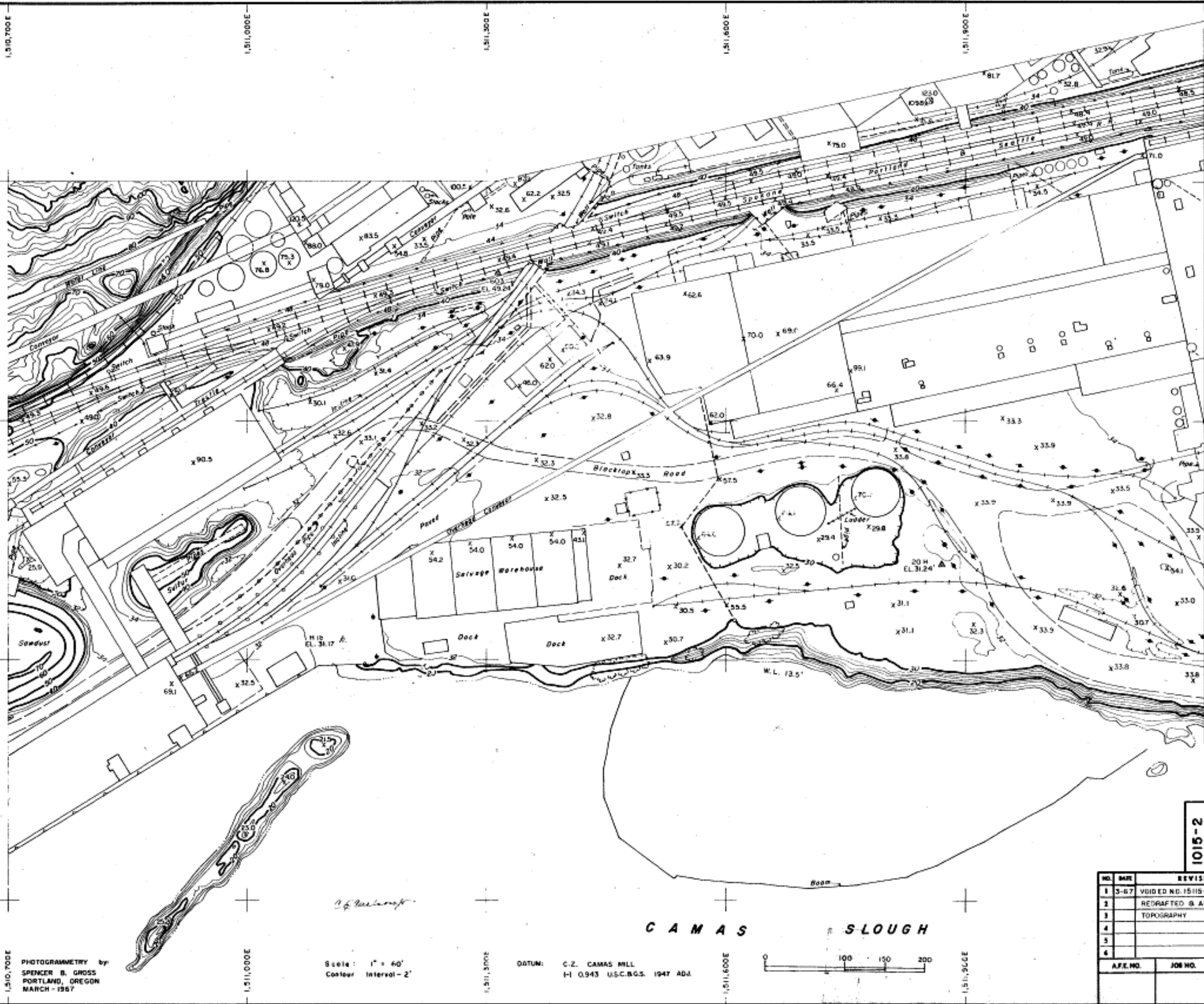

**MEYERS & CARLSON**  
 CONSULTING ENGINEERS  
 PORTLAND, OREGON  
 MECHANICAL CIVIL  
 CHEMICAL INDUSTRIAL

NO.	DATE	REVISIONS
1	3-67	VOIDED NO. 15115-DATED 9-14-66
2		REDRAFTED & ADDED ADDITIONAL
3		TOPOGRAPHY
4		
5		
6		

**CAMAS MILLSITE**  
**SOUTH CENTRAL SECTION**  
 DRAWN BY CEC  
 DATE: MARCH-1967  
 SCALE NOTED  
**CROWN ZELLERBACH CORP.**  
 CAMAS, WASHINGTON

PHOTOGRAMMETRY by  
 SPENCER B. GROSS  
 PORTLAND, OREGON  
 MARCH-1967

Scale: 1" = 40'  
 Contour Interval - 2'

DATUM: C.Z. CAMAS MILL  
 H- 0.943 U.S.C.B.G.S. 1947 ADJ.

