

PHASING PLAN FOR:

THE HILLS AT ROUND LAKE P.R.D.

OLSON LAND SURVEYORS
ENGINEERS
ENGINEERING INC. 1111 BROADWAY, VANCOUVER, WA 98660

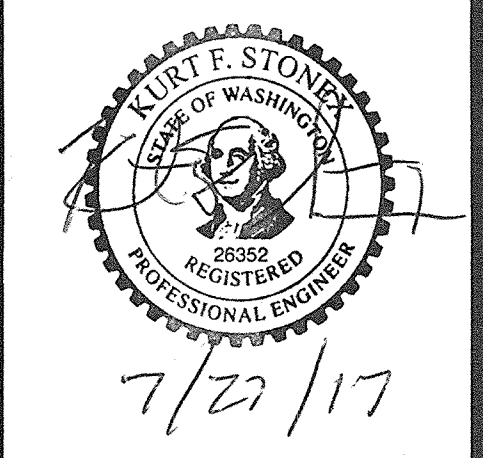

CHANGES / REVISIONS

DESCRIPTION	DATE
REV'S PER CITY OF CAMAS COMMENTS	08/24/10
REV'S PER CITY OF CAMAS COMMENTS	09/22/10
REV'S FOR LOTS/TRACTS IN PHASES 5, 6, 7, REV'S FOR PHASING	02/21/14
REV'S FOR LOT NUMBERS IN PHASES 5, 6, 7; ADD PHASE NUMBERS	03/13/14
REVISE PHASES 8, 9, 10 & 11	02/26/16
ADD PHASE NUMBERS	05/23/16
PHASE 12 & 13 REVISIONS	07/25/17
PHASE 12 & 13 REVISIONS	07/27/17

DESIGNED: WP/OEI
DRAWN: REB/MRO
CHECKED: KFS
DATE: AUGUST 2010
SCALE: H: 1" = 100'
V:
COPYRIGHT 2014, OLSON ENGINEERING, INC.
THE HILLS AT ROUND LAKE
JOB NO. 7436.03.02
SHEET
MP2

PHASING NOTES

- PHASING SHALL GENERALLY FOLLOW THE PHASING LINES AS INDICATED ON THE PLAN WITH UP TO 14 PHASES. PHASING LINES MAY BE ADJUSTED SLIGHTLY DEPENDING ON MARKET CONDITIONS, CONSTRUCTION RELATED ISSUES, ETC. EVEN THOUGH PHASES ARE LISTED AS PHASES 1 THROUGH 13, PHASING SHALL NOT NECESSARILY FOLLOW ANY PREDETERMINED ORDER. SOME PHASES MAY BE CONSTRUCTED SIMULTANEOUSLY.
- MANY PHASES WILL EITHER REQUIRE FILL MATERIAL OR WILL REQUIRE REMOVAL OF MATERIAL IN ORDER TO ESTABLISH FINAL LOT AND/OR ROAD GRADES. DEPENDING ON THE ORDER OF CONSTRUCTION, THE MATERIAL MAY BE BORROWED FROM OR STOCKPILED IN OTHER PHASES.

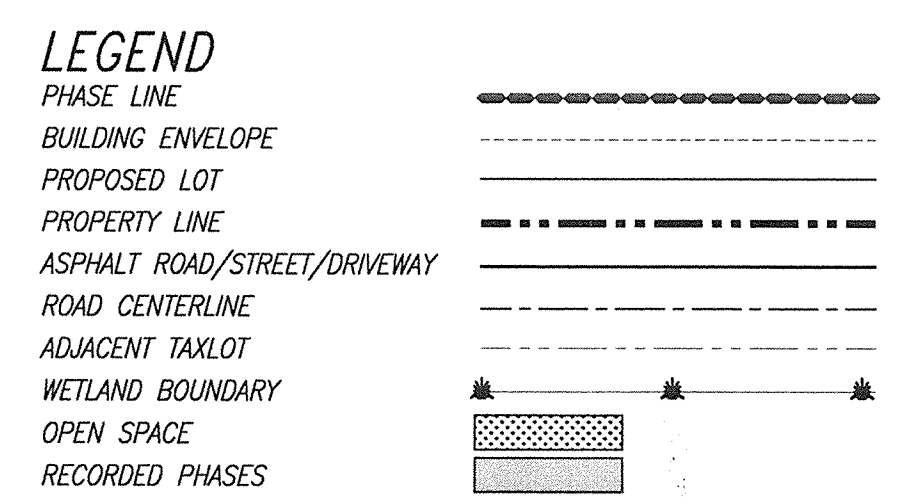

APPLICANT/OWNER:
HILLS AT ROUND LAKE, LLC
P.O. BOX 87970
VANCOUVER, WA 98687
PH: (360) 907-5746

CONTACT:
OLSON ENGINEERING, INC.
ATTN: MIKE ODREN
1111 BROADWAY
VANCOUVER, WA 98660
(360) 695-1385
FAX (360) 695-8117
mkeo@olsonengr.com

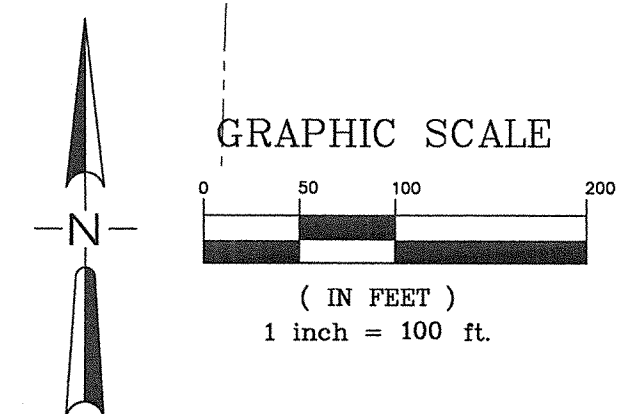

THIS SITE PLAN PROVIDED BY HARPER HOUF PETERSON RIGHELLIS FOR WOODBURN ELEMENTARY SCHOOL AND IS SHOWN FOR REFERENCE ONLY.

T.L. 23
123426-000
CHARLES & HAZEL FARRELL

T.L. 15
123209-000
CHARLES & HAZEL FARRELL

T.L. 38
123232-000
JOSEPH & MARTHA WHITLER TRST

T.L. 14
123208-000
CLAYTON & GEORGIA SMITH

T.L. 35
123232-000
RICHARD & PAULETTE SELL

T.L. 36
123230-000
LOUISE C BOURCIEUR

T.L. 33
123227-000
FRANCIS E BOURCIEUR

T.L. 31,32
123226-000
PL & HELEN BOURCIEUR

T.L. 3,8
123200-000
WILLIE & KRISTYNN SANDRY

T.L. 4/1
178377-002
LEONARD & LINDA COOPER

T.L. 36
178413-000
GERALD & JANICE UHACZ

T.L. 40
178417-000
JAMES & CAROL ADAMS

T.L. 2
178424-005
GORDON & LORELL RISNER

T.L. 6
3103-000
HERBERT J MEYER

PENS: /consultant3.ctb
PLOT: j:/data/7000/7400/7430/7436/SCHOOL EXHIBIT/7436.p.master.plan.dwg