



LAND SURVEYORS
ENGINEERS

(360) 695-1385
222 E. Evergreen Blvd
Vancouver, WA
98660

Legal Description for the City of Camas
Grand Ridge Annexation Area

May 19, 2015

A parcel of property in the Joel Knight and the Lafayette Durgan Donation Land Claims and being a portion of Section 8, Township 1 North, Range 3 East of the Willamette Meridian, Clark County, Washington, described as follows:

BEGINNING at the Southwest corner of Breckenridge, a subdivision recorded in Book 311 at Page 715, Clark County records and the West boundary of that annexation parcel described in City of Camas Ordinance 2435, approved January 3, 2006;

THENCE North 01° 56' 30" East along the West line of said Breckenridge subdivision and the West line of said annexation parcel 79.33 feet, more or less, to the North corner of the Saranchuk tract as described in that document recorded under Auditor's File No. 3826894, Clark County records, said North corner being on the East line of the "124 acre 192nd Avenue/ Washington State Department of Transportation" annexation parcel described in City of Vancouver Ordinance M-3707;

THENCE South 13° 38' 06" West along the East line of said annexation parcel boundary 1326.93 feet to a point on the South line of the Northwest of said Section 8;

THENCE North 88° 54' 13" West along said South line and following the boundary of said annexation parcel 99 feet, more or less, to the an angle point in the Easterly boundary line of said annexation parcel;

THENCE Southwesterly, along said Easterly boundary line 600 feet, more or less, to the South right of way line of State Route 14;

THENCE Westerly, along said South right of way line and along the South boundary of said annexation parcel 700 feet, more or less, to the East line of the "330 -Acre Columbia River Annexation" parcel described in City of Vancouver Ordinance M-3949;

THENCE Southwesterly, along said East line 400 feet, more or less to the ordinary high water line of the Columbia River;

THENCE Easterly, along said ordinary high water line 4100 feet, more or less, to the East line of the Southeast quarter of said Section 8;

THENCE North, along the East line of said Southeast quarter 250 feet, more or less, to the South right of way line of the Burlington Northern Railroad;

THENCE Westerly, along said South right of way line and along the South boundary of that annexation parcel described per City of Camas Ordinance Number 1531 a distance of 650 feet, more or less, to an angle point in said annexation parcel's boundary;

THENCE North, along said annexation parcel boundary per said Ordinance 1531 a distance of 205.33 feet to the South right of way line of State Route 14;

THENCE Westerly, along said South right of way line and along said annexation parcel boundary per said Ordinance 1531 a distance of 300 feet, more or less, to the East line of said Knight Donation Land Claim;

THENCE North along the East line of said Knight Donation land Claim and along said annexation boundary per said Ordinance 1531 a distance of 1700 feet, more or less, to the Northerly right-of-way line of S.E. Brady Road;

THENCE Southwesterly along said Northerly right-of-way line a distance of 1740 feet more or less to the Southeast corner of Lot 3 of Vista Del Rio No. 2, a subdivision recorded as Vista Del Rio No. 1 & 2 in Volume G of Plats at Page 165 of said Clark County records;

THENCE Northwesterly long the South line of said Lot 3 a distance of 69.80 feet to the Southeast corner of Lot 2 of said Vista Del Rio No. 2 subdivision;

THENCE Westerly along the South line of Lots 1 and 2 of said subdivision a distance of 220 feet more or less to the Southwest corner of said Lot 1;

THENCE Westerly along the North line of those tracts conveyed to Jada Z. Prane and Richard C. Woolfe by deed recorded under Auditor's File No. 4981817 of said Clark County records a distance of 120 feet more or less to said West line of the Joel Knight Donation Land Claim;

(360) 695-1385
222 E. Evergreen Blvd
Vancouver, WA
98660

THENCE North $01^{\circ}56'30''$ East along the West line of said Knight Donation Land
Claim a distance of 1260 feet more or less to the POINT OF BEGINNING.

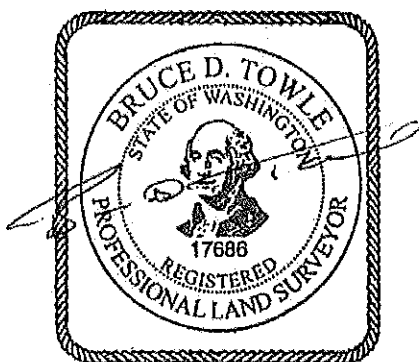

5/19/15