

EXHIBIT "A"



LAND SURVEYORS
ENGINEERS

(360) 695-1385
222 E. Evergreen Blvd.
Vancouver, WA
98660

LEGAL DESCRIPTION FOR CITY OF CAMAS
Grand Ridge Annexation – 2 Perimeter Description

September 28, 2015

A parcel of property in the Joel Knight and the Lafayette Durgan Donation Land Claims and being a portion of Section 8, Township 1 North, Range 3 East of the Willamette Meridian, Clark County, Washington, described as follows:

BEGINNING at the Southwest corner of Breckenridge, a subdivision recorded in Book 311 at Page 715, Clark County records and the West boundary of that annexation parcel described in City of Camas Ordinance 2435, approved January 3, 2006;

THENCE South $89^{\circ} 45' 44''$ East along the South line of said Plat of Breckenridge and the North lines of Grand Ridge Phase IV as recorded in Book 311 of Plats at Page 367 of Plats and Grand Ridge Phase I as recorded in Book 310 at Page 590 of Plats of Clark County records, a distance of 659.52 feet to an angle point in the North line of said Grand Ridge Phase 1;

THENCE North $00^{\circ} 42' 41''$ West along said North line a distance of 27.00 feet to an angle point in said North line;

THENCE North $88^{\circ} 05' 40''$ East along said North line a distance of 718.98 feet to the West line of Grand Ridge Phase II as recorded in Book 310 of Plats at Page 854 of said Clark County records;

THENCE North $01^{\circ} 52' 08''$ East along said West line a distance of 34.62 feet to the North line of said Grand Ridge Phase II;

THENCE South $89^{\circ} 02' 51''$ East along said North line a distance of 49.53 feet to an angle point in said North line;

THENCE South $00^{\circ} 32' 18''$ East along said North line a distance of 41.49 feet to an angle point in said North line;

THENCE North $88^{\circ} 19' 36''$ East along said North line a distance of 556.62 feet to the Northeast corner of said Grandview Ridge Phase II Plat;

THENCE South $01^{\circ} 10' 42''$ East along the East line of said Grand Ridge Phase II plat a distance of 847.79 feet to the Northerly right-of-way line of S.E. Brady Road;

THENCE Southwesterly along said Northerly right-of-way line a distance of 1740 feet more or less to the Southeast corner of Lot 3 of Vista Del Rio No. 2, a subdivision recorded as Vista Del Rio No. 1 & 2 in Volume G of Plats at Page 165 of said Clark County records;

THENCE Northwesterly along the South line of said Lot 3 a distance of 69.80 feet to the Southeast corner of Lot 2 of said Vista Del Rio No. 2 subdivision;

THENCE Westerly along the South line of Lots 1 and 2 of said subdivision a distance of 220 feet more or less to the Southwest corner of said Lot 1;

THENCE Westerly along the North line of those tracts conveyed to Jada Z. Prane and Richard C. Woolfe by deed recorded under Auditor's File No. 4981817 of said Clark County records a distance of 120 feet more or less to said West line of the Joel Knight Donation Land Claim;

THENCE North $01^{\circ} 56' 30''$ East along the West line of said Knight Donation Land Claim a distance of 1260 feet more or less to the POINT OF BEGINNING.

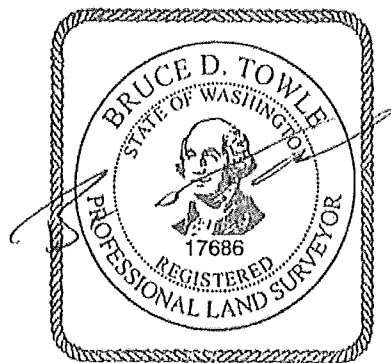

9/29/15