

LEGAL DESCRIPTION FOR CITY OF CAMAS
Winchester Hills Annexation
Perimeter Description

July 27, 2016

A parcel of property in the Northwest quarter of Section 8 and the Southwest quarter of Section 5, all in Township 1 North, Range 3 East of the Willamette Meridian, Clark County, Washington, described as follows:

BEGINNING at the intersection of the West Line of the Joel Knight Donation Land Claim and the Easterly projection of the South line of Winchester Hills Phase-2, a subdivision recorded in Book 310 at Page 631, Clark County records;

THENCE North $88^{\circ} 10' 24''$ West along said Easterly projection and said South line of Winchester Hills Phase-2 a distance of 2085.55 feet more or less to a point on the East line of Tract F of said subdivision, said point also being on the Easterly line of that parcel annexed to the City of Vancouver, Washington per annexation Ordinance M-3707;

THENCE Northerly, along said Easterly line of said annexation 600 feet, more or less, to the North line of said Winchester Hills Phase-2;

THENCE North $88^{\circ} 20' 23''$ East along said North line a distance of 165 feet, more or less, to the Northwest corner of Tract H, Winchester Hills Phase-1 a subdivision recorded in Book J at Page 510, Clark County records;

THENCE North $88^{\circ} 20' 23''$ East along the North line of said Tract H, 925.94 feet to the East line of the Hutson Martin Donation Land Claim;

THENCE North $00^{\circ} 49' 29''$ West along said East line 1645 feet, more or less to a point on the Westerly line of that parcel annexed to the City of Camas, Washington per annexation Ordinance 1518, said point also being on the "Northerly line of S.E. Payne Road" as described in said Ordinance;

(360) 695-1385
222 E. Evergreen Blvd.
Vancouver, WA
98660

THENCE Southeasterly, along the Westerly line of said Ordinance 1518 and the Northeasterly line of said S.E. Payne Road 1900 feet, more or less, to the West line of said Knight Donation Land Claim;

THENCE South, along said West line 716 feet, more or less, to the POINT OF BEGINNING.

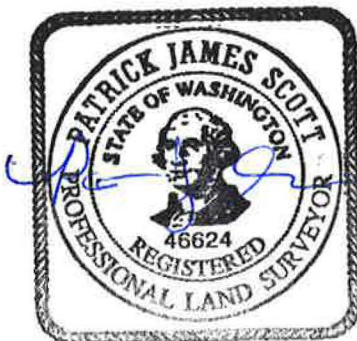

7-29-2016



Winchester Hills Area

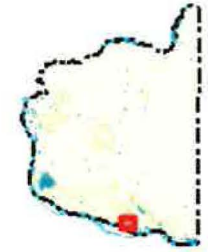

- Legend**
- Urban Growth Area Boundary
 - City Limits
 - Building Footprints
 - Taxlots
 - County Outline
 - World Street Map

Notes:

1: 15,237



WGS_1984_Web_Mercator_Auxiliary_Sphere
Clark County, WA. GIS - <http://gis.clark.wa.gov>

This map was generated by Clark County's "MapsOnline" website. Clark County does not warrant the accuracy, reliability or timeliness of any information on this map, and shall not be held liable for losses caused by using this information.