

PHASING PLAN FOR:

**THE HILLS AT ROUND LAKE P.R.D.**

**OLSON** LAND SURVEYORS  
ENGINEERS  
ENGINEERING INC. 1111 BROADWAY, VANCOUVER, WA 98660

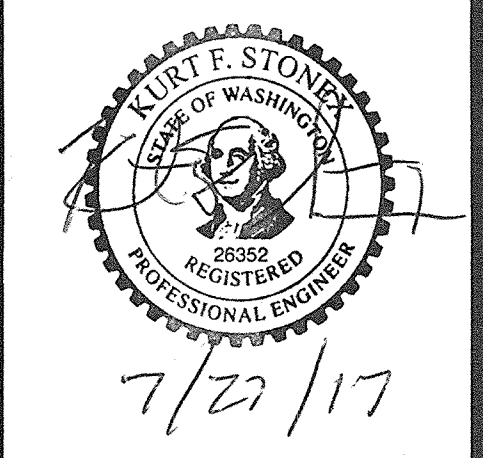

CHANGES / REVISIONS

DESCRIPTION	DATE
REV'S PER CITY OF CAMAS COMMENTS	08/24/10
REV'S PER CITY OF CAMAS COMMENTS	09/22/10
REV'S FOR LOTS/TRACTS IN PHASES 5, 6, 7, REV'S FOR PHASING	02/21/14
REV'S FOR LOT NUMBERS IN PHASES 5, 6, 7, ADD PHASE NUMBERS	03/13/14
REVISE PHASES 8, 9, 10 & 11	02/26/16
ADD PHASE NUMBERS	05/23/16
PHASE 12 & 13 REVISIONS	07/25/17
PHASE 12 & 13 REVISIONS	07/27/17

DESIGNED: WP/OEI  
DRAWN: REB/MRO  
CHECKED: KFS  
DATE: AUGUST 2010  
SCALE: H: 1" = 100'  
V:  
COPYRIGHT 2014, OLSON ENGINEERING, INC.  
THE HILLS AT ROUND LAKE  
JOB NO. 7436.03.02  
**SHEET**  
MP2

**PHASING NOTES**

- PHASING SHALL GENERALLY FOLLOW THE PHASING LINES AS INDICATED ON THE PLAN WITH UP TO 14 PHASES. PHASING LINES MAY BE ADJUSTED SLIGHTLY DEPENDING ON MARKET CONDITIONS, CONSTRUCTION RELATED ISSUES, ETC. EVEN THOUGH PHASES ARE LISTED AS PHASES 1 THROUGH 13, PHASING SHALL NOT NECESSARILY FOLLOW ANY PREDETERMINED ORDER. SOME PHASES MAY BE CONSTRUCTED SIMULTANEOUSLY.
- MANY PHASES WILL EITHER REQUIRE FILL MATERIAL OR WILL REQUIRE REMOVAL OF MATERIAL IN ORDER TO ESTABLISH FINAL LOT AND/OR ROAD GRADES. DEPENDING ON THE ORDER OF CONSTRUCTION, THE MATERIAL MAY BE BORROWED FROM OR STOCKPILED IN OTHER PHASES.

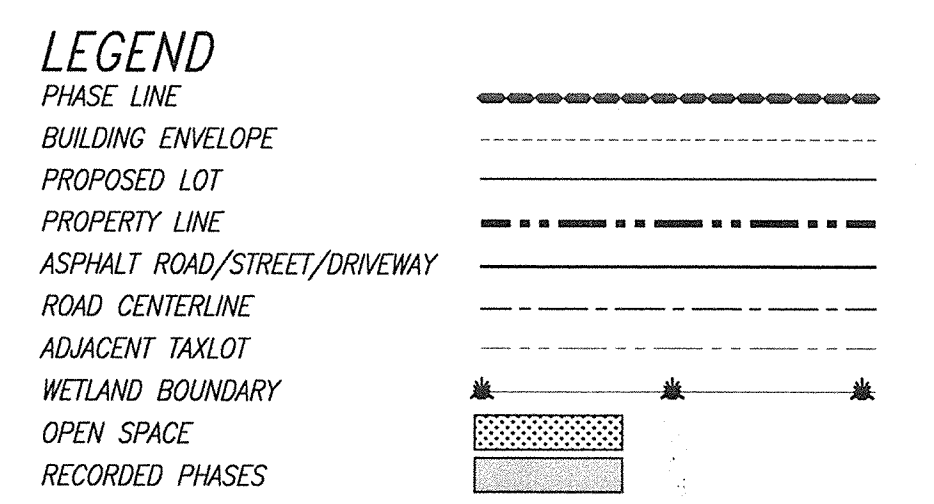

APPLICANT/OWNER:  
HILLS AT ROUND LAKE, LLC  
P.O. BOX 87970  
VANCOUVER, WA 98687  
PH: (360) 907-5746

CONTACT:  
OLSON ENGINEERING, INC.  
ATTN: MIKE ODREN  
1111 BROADWAY  
VANCOUVER, WA 98660  
(360) 695-1385  
FAX (360) 695-8117  
mkeo@olsonengr.com

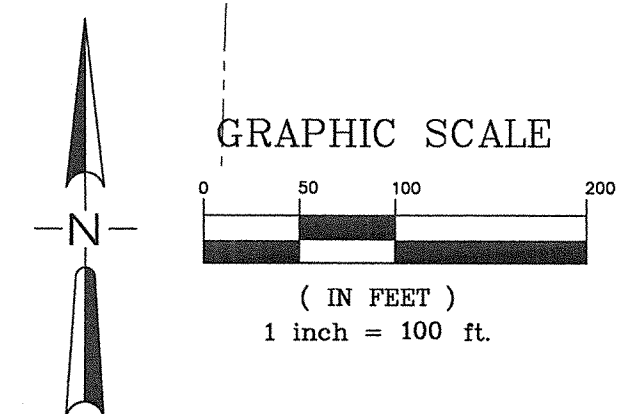

PENS: /consultant3.ctb  
PLOT: j:/data/7000/7400/7430/7436/SCHOOL EXHIBIT/7436.p.master.plan.dwg