

SYMBOL LEGEND	
SYMBOL	DESCRIPTION
● ○	EXISTING TREE TO BE RETAINED
○	EXISTING TREE TO BE REMOVED, REFER TO TREE SURVEY FOR SPECIES AND SIZES.

TREE LOCATIONS AND SIZES HAVE BEEN OBTAINED FROM AN EXISTING CONDITIONS SURVEY PROVIDED BY M4G SURVEYING.
 SURVEYOR TO LOCATE TREES ALONG PROPERTY LINE. NO TREE WITH ANY PORTION OF THE TREE TRUNK ON NEIGHBORING PROPERTY OR OFF-SITE SHALL BE CUT DOWN WITHOUT CONSENT OF CO-TENANT NEIGHBOR.
 ALL TREES WITHIN WETLAND AREAS (NOT SHOWN) SHALL BE RETAINED.

TREE PROTECTION STANDARDS

- WHERE NOTED BELOW THE CRITICAL ROOT ZONE SHALL BE DEFINED AS A RADIUS AROUND EACH TREE EQUAL TO ONE FOOT OF RADIUS PER 1 INCH OF TREE DBH (DIA. AT BREAST HEIGHT).
- PLACING MATERIALS NEAR TREES, NO PERSON MAY CONDUCT ANY ACTIVITY WITHIN THE PROTECTED AREA OF ANY TREE DESIGNATED TO REMAIN, INCLUDING, BUT NOT LIMITED TO, PARKING EQUIPMENT, PLACING SOLVENTS, STORING BUILDING MATERIAL AND SOIL DEPOSITS, DUMPING CONCRETE WASHOUT AND LOCATING BURN HOLES.
 - ATTACHMENT TO TREES, DURING CONSTRUCTION, NO PERSON SHALL ATTACH ANY OBJECT TO ANY TREE DESIGNATED FOR PROTECTION.
 - PROTECTIVE BARRIER, BEFORE DEVELOPMENT, LAND CLEARING, FILLING OR ANY LAND ALTERATION, THE APPLICANT:
 - SHALL ERECT AND MAINTAIN READILY VISIBLE PROTECTIVE TREE FENCING ALONG THE OUTER EDGE AND COMPLETELY SURROUNDING THE PROTECTED AREA OF ALL PROTECTED TREES OR GROUPS OF TREES. FENCES SHALL BE CONSTRUCTED OF CHAIN LINK OR OTHER APPROVED MATERIAL AND AT LEAST FOUR FEET HIGH, UNLESS OTHER TYPE OF FENCING IS AUTHORIZED BY THE CITY OF CAMAS.
 - MAY BE REQUIRED TO COVER, WITH MULCH TO A DEPTH OF AT LEAST SIX (6) INCHES OR WITH FLYWOOD OR SIMILAR MATERIAL, THE AREAS ADJOINING THE CRITICAL ROOT ZONE OF A TREE IN ORDER TO PROTECT ROOTS FROM DAMAGE CAUSED BY HEAVY EQUIPMENT.
 - SHALL PROHIBIT EXCAVATION OR COMPACTION OF EARTH OR OTHER POTENTIALLY DAMAGING ACTIVITIES WITHIN THE BARRIERS.
 - MAY BE REQUIRED TO MINIMIZE ROOT DAMAGE BY EXCAVATING A TWO (2) FOOT DEEP TRENCH TO CLEANLY SEVER THE ROOTS OF TREES TO BE RETAINED.
 - SHALL MAINTAIN THE PROTECTIVE BARRIERS IN PLACE UNTIL THE CITY OF CAMAS AUTHORIZES THEIR REMOVAL OR A FINAL CERTIFICATE OF OCCUPANCY IS ISSUED, WHICHEVER OCCURS FIRST.
 - SHALL ENSURE THAT ANY LANDSCAPING DONE IN THE PROTECTED ZONE SUBSEQUENT TO THE REMOVAL OF THE BARRIERS SHALL BE ACCOMPLISHED WITH LIGHT MACHINERY OR HAND LABOR.
 - GRADE
 - THE GRADE SHALL NOT BE ELEVATED OR REDUCED WITHIN THE CRITICAL ROOT ZONE OF TREES TO BE PRESERVED WITHOUT THE CITY OF CAMAS' AUTHORIZATION. COVERAGE OF UP TO ONE HALF OF THE AREA OF THE TREE'S CRITICAL ROOT ZONE WITH LIGHT SOILS (NO CLAY) TO THE MINIMUM DEPTH NECESSARY TO CARRY OUT GRADING OR OR LANDSCAPE PLANS, IF IT WILL NOT IMPERIL THE SURVIVAL OF THE TREE MAY BE ALLOWED. AERATION DEVICES MAY BE REQUIRED TO ENSURE THE TREE'S SURVIVAL.
 - IF THE GRADE ADJACENT TO A PRESERVED TREE IS RAISED SUCH THAT IT COULD SLOUGH OR ERODE INTO THE TREE'S CRITICAL ROOT ZONE, IT SHALL BE PERMANENTLY STABILIZED TO PREVENT SUFFOCATION OF THE ROOTS.
 - THE APPLICANT SHALL NOT INSTALL AN IMPERVIOUS SURFACE WITHIN THE CRITICAL ROOT ZONE OF ANY TREE TO BE RETAINED.
 - TO THE GREATEST EXTENT PRACTICAL, UTILITY TRENCHES SHALL BE LOCATED OUTSIDE OF THE CRITICAL ROOT ZONE OF TREES TO BE RETAINED.
 - TREES AND OTHER VEGETATION TO BE RETAINED SHALL BE PROTECTED FROM EROSION AND SEDIMENTATION. CLEARING OPERATIONS SHALL BE CONDUCTED SO AS TO EXPOSE THE SMALLEST PRACTICAL AREA OF SOIL TO EROSION FOR THE LEAST POSSIBLE TIME. TO CONTROL EROSION, SHRUBS, GROUND COVER AND STUMPS SHALL BE MAINTAINED ON THE INDIVIDUAL LOTS, WHERE FEASIBLE. WHERE NOT FEASIBLE APPROPRIATE EROSION CONTROL PRACTICES SHALL BE IMPLEMENTED.
 - DIRECTIONAL FELLING, DIRECTIONAL FELLING OF TREES SHALL BE USED TO AVOID DAMAGE TO TREE DESIGNATED FOR RETENTION.
 - AS RESULT OF FURTHER REVIEW, SOME EXISTING TREES MARKED FOR PRESERVATION MAY NEED TO BE REMOVED TO ACCOMMODATE FINAL GRADING PLANS AND STORMWATER FACILITIES. IN THE EVENT IT BECOMES NECESSARY TO REMOVE A TREE THAT IS PROPOSED TO BE RETAINED, APPROVAL SHALL BE OBTAINED FROM THE CITY OF CAMAS AND ADDITIONAL MITIGATION TREES MAY BE REQUIRED.

TREE PRESERVATION NARRATIVE

ALL TREES WITHIN THE WETLAND & WETLAND BUFFER AREAS AS WELL AS THE PROJECT PERIMETER ARE PROPOSED TO BE RETAINED.
 TREES ARE PROPOSED TO BE REMOVED CONFLICT WITH STREET IMPROVEMENTS, SITE GRADING, UTILITIES, AND BUILDING ENVELOPES.

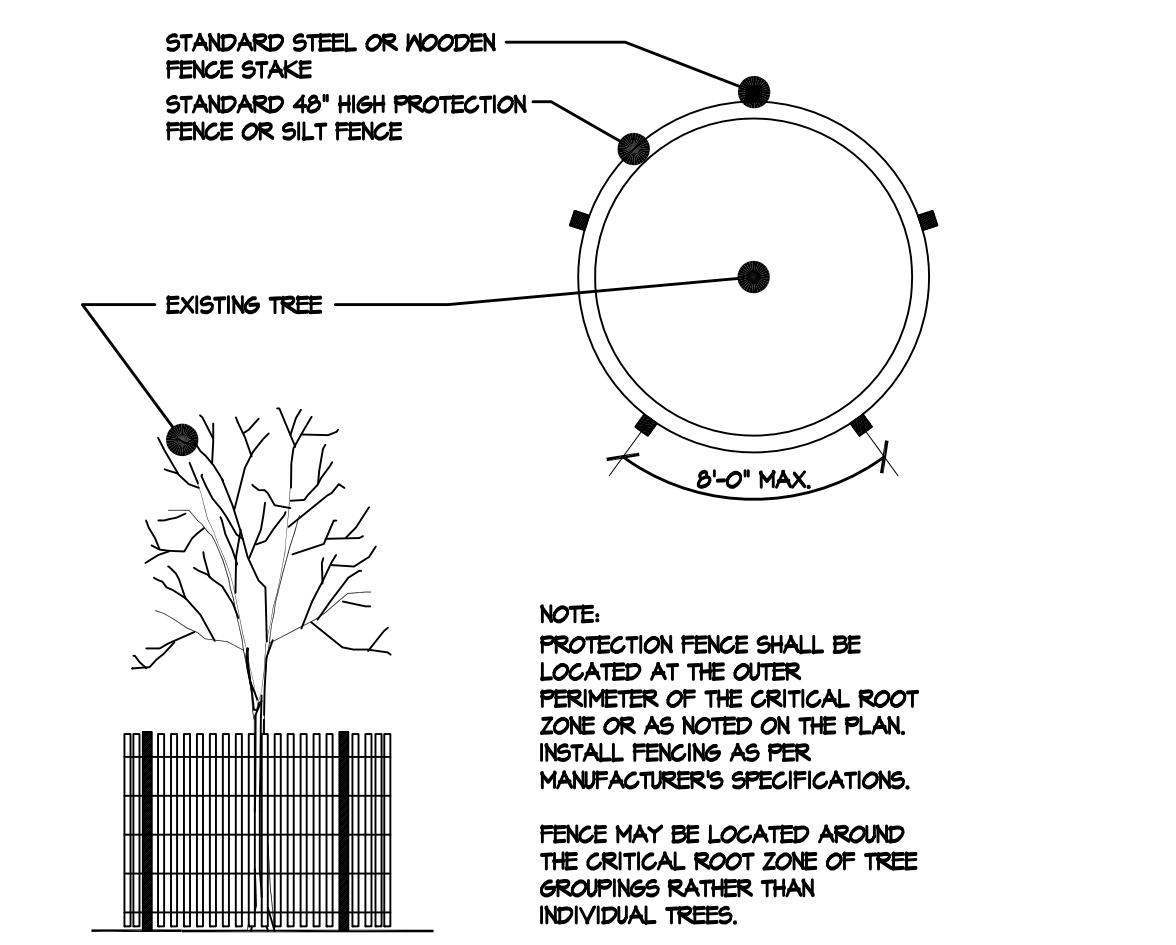

A Tree Protection Fencing Detail
 Not To Scale SECTION / PLAN VIEW

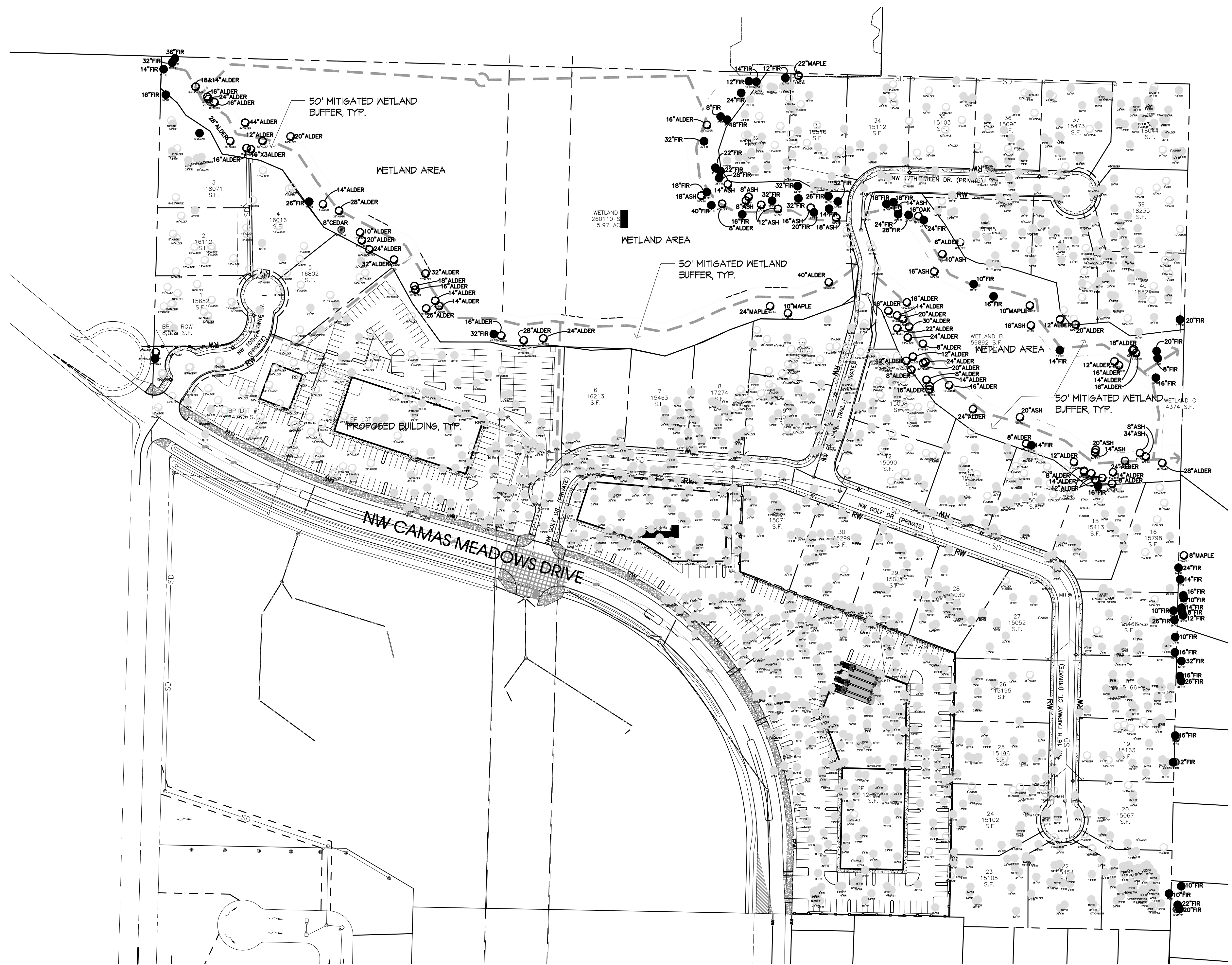
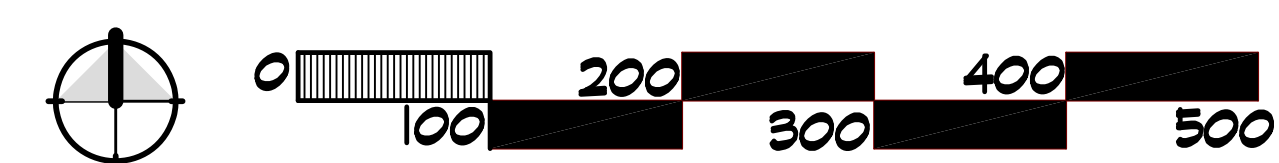

© COPYRIGHT 2015, PLANNING SOLUTIONS, INC. NO PART OF THIS DRAWING MAY BE COPIED OR REPRODUCED WITHOUT WRITTEN PERMISSION OF PLANNING SOLUTIONS, INC.

DISCLAIMER AND LIMITATIONS: ANY WORK CONTAINED HEREIN INCLUDING BUT NOT LIMITED TO PLANS AND DOCUMENTS ARE INSTRUMENTS OF SERVICE INTENDED FOR USE SOLELY WITH RESPECT TO THIS PROJECT. ALL WORK SHALL BE CONSIDERED CONCEPTUAL AND SUBJECT TO CHANGE. THESE INSTRUMENTS OF SERVICE SHALL BE CONSIDERED A WORK IN PROGRESS WHERE UNKNOWN FACTORS EXIST AND JURISDICTIONAL REQUIREMENTS HAVE NOT BEEN VERIFIED. DUE TO THE HIGH DEGREE OF UNCERTAINTY ASSOCIATED WITH A CONCEPTUAL DESIGN, THESE INSTRUMENTS OF SERVICE SHALL NOT BE USED AS THE BASIS FOR A FINANCIAL EVALUATION OR CONSTRUCTION COST ESTIMATES. NO ASSURANCES ARE OFFERED OR IMPLIED AS TO THE OVERALL FEASIBILITY OF THE PROJECT. ALL WORK SHALL BE SUBJECT TO REVIEW AND FINAL APPROVAL BY ALL APPROPRIATE FEDERAL, STATE AND LOCAL AGENCIES AND SHALL CONTAIN THE PROFESSIONAL SEAL AND SIGNATURE OF ALL REQUIRED DESIGN PROFESSIONALS PRIOR TO ANY USE OF THESE DOCUMENTS. PLANNING SOLUTIONS, INC. AND ITS CONSULTANTS SHALL BE DEEMED THE AUTHORS AND OWNERS OF THEIR RESPECTIVE INSTRUMENTS OF SERVICE AND SHALL RETAIN ALL COMMON LAW, STATUTORY AND OTHER RESERVED RIGHTS, INCLUDING COPYRIGHTS.